

Rev	Description	Date
A	Preliminary layout	27-10-15
B	Layout modified following Meeting held on 2nd November	04-11-15
C	Soft Seating Areas Updated	18-11-15
D	Extra benching included	24-11-15

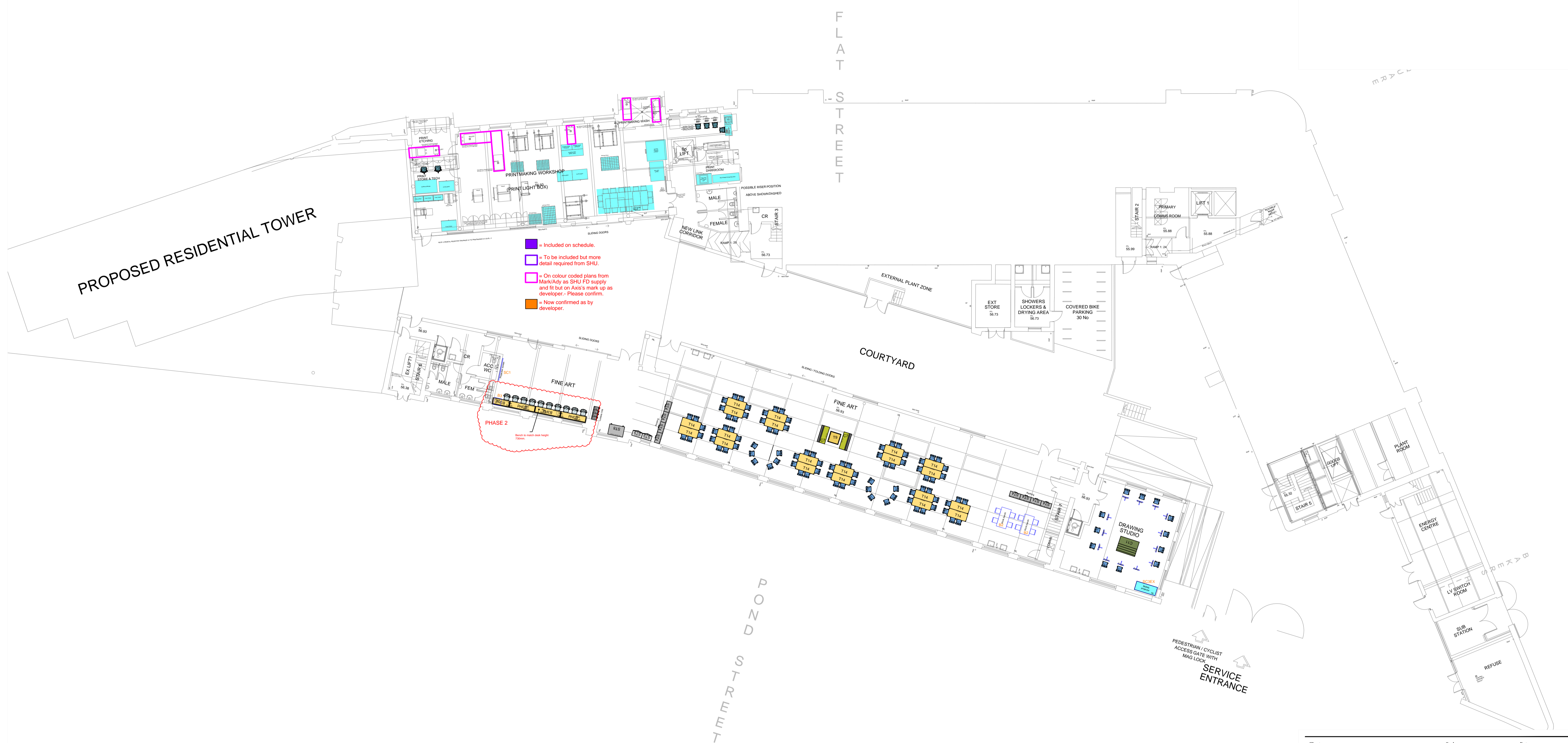

# Sheffield Hallam University / Head Post Office Level -2

Client	Scale	Date
Sheffield Hallam University	1:125 @ A1	24/11/15
Project	Drawn	ASM
Head Post Office	Mark Richards	Jacqui Morris
Description	Drawing number	
Lower Basement (Level -2)	DWG-JM077MR-151124-LF1	
Status	Revision	Option
Preliminary	D	1

**GODFREY SYRETT**

