

| Rev | Description | Date |
|-----|--|----------|
| A | Preliminary layout | 27-10-15 |
| B | Layout modified following Meeting held on 2nd November | 04-11-15 |
| C | Extra benching included | 24-11-15 |

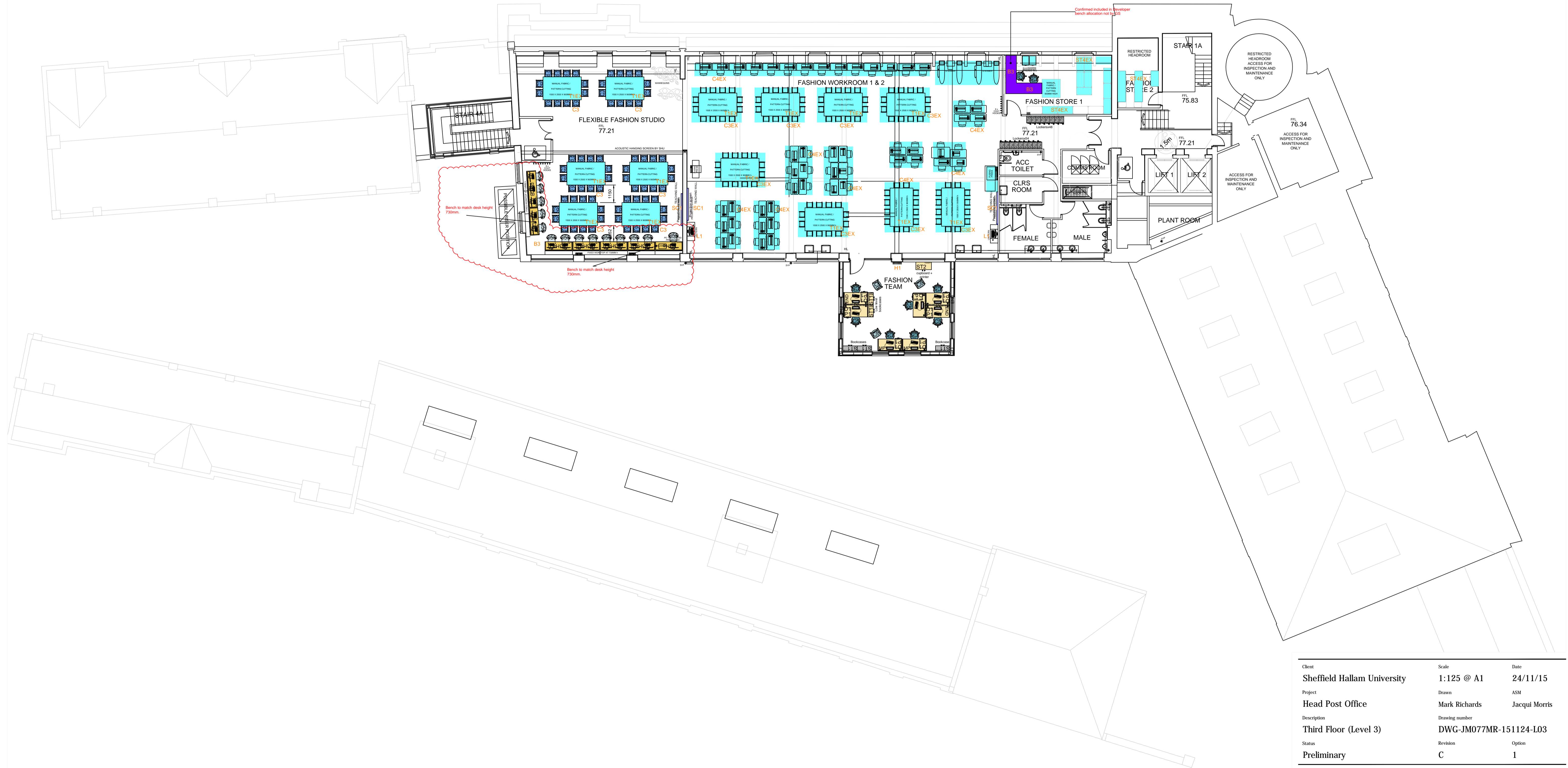

| | | |
|-----------------------------|------------------------|---------------|
| Client | Scale | Date |
| Sheffield Hallam University | 1:125 @ A1 | 24/11/15 |
| Project | Drawn | ASM |
| Head Post Office | Mark Richards | Jacqui Morris |
| Description | Drawing number | |
| Third Floor (Level 3) | DWG-JM077MR-151124-L03 | |
| Status | Revision | Option |
| Preliminary | C | 1 |

