

Rev	Description	Date
A	Preliminary layout	27-10-15
B	Layout modified following Meeting held on 2nd November	04-11-15
C	Soft Seating Areas Updated	18-11-15
D	Extra benching included	24-11-15

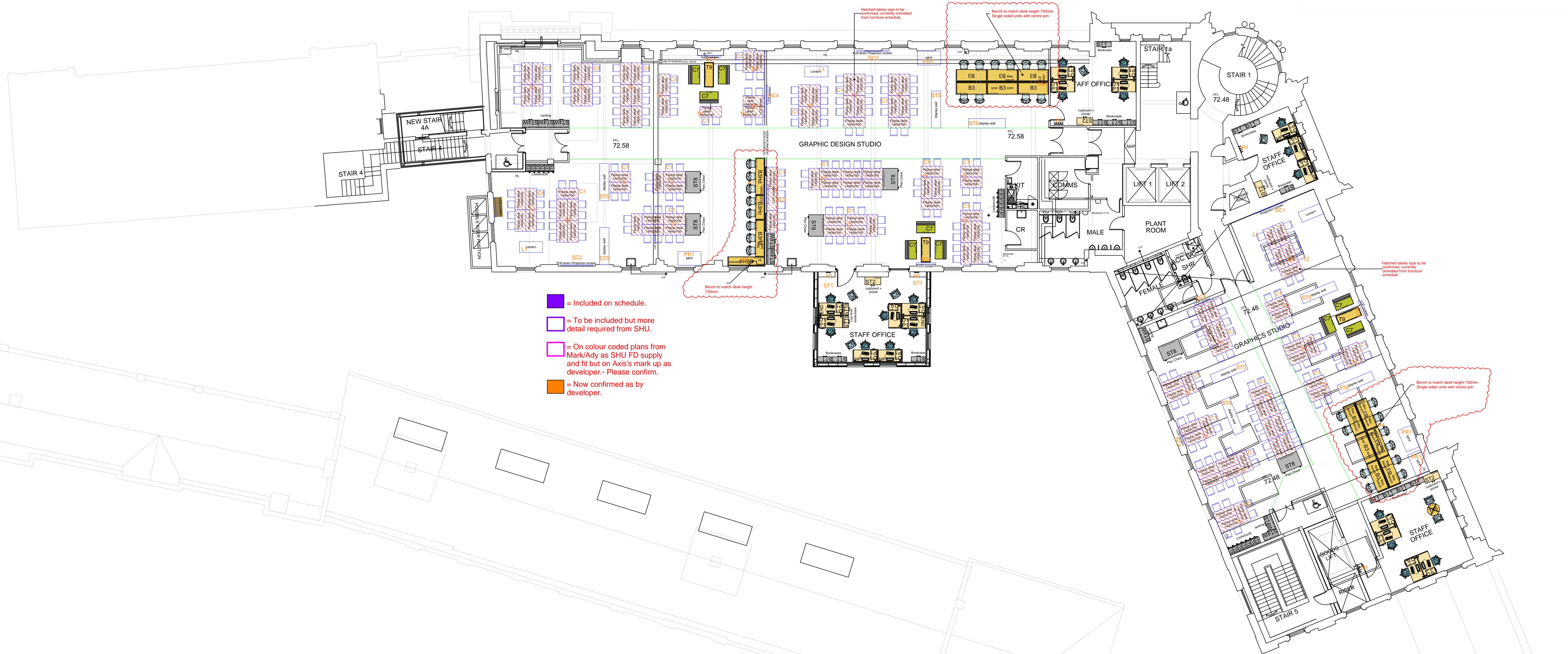

- = Included on schedule.
- = To be included but more detail required from SHU.
- = On colour coded plans from Mark/Ady as SHU FD supply and fit but on Axis's mark up as developer.- Please confirm.
- = Now confirmed as by developer.

Client	Scale	Date
Sheffield Hallam University	1:125 @ A1	18/11/15
Project	Drawn	ASM
Head Post Office	Mark Richards	Jacqui Morris
Description	Drawing number	
Second Floor (Level 2)	DWG-JM077MR-151118-L02	
Status	Revision	Option
Preliminary	C	1

**GODFREY SYRETT**

